

CUSHMAN, STEVEN E
529 WEEKS MILLS ROAD
WINDSOR ME 04363

B12345P151

Previous Owner
GAY, REGINALD H., SR.
c/o CUSHMAN, STEVEN E.
336 PACKARD ROAD
MONMOUTH ME 04259
Sale Date: 7/08/2016

Inspection Witnessed By:

X	Date
No./Date	Description
	Date Insp.

Notes:
9/25/17 CHANGED ADDRESS FROM 336 PACKARD ROAD,
MONMOUTH, ME 04259 TO 529 WEEKS MILLS ROAD,
WINDSOR, ME 04363. TLH
11/23 - DB MEASURE INFO, DIRT FLOOR BASEMENT
7/24 KL FR . UC=4/25 PU ADD . 17'X24' DEMO'D

Windsor

Property Data			Assessment Record																																																																																																																																																																																																																		
Neighborhood 11 Nbh			Year	Land	Buildings	Exempt	Total																																																																																																																																																																																																														
Tree Growth Year 0			2011	17,000	110,600	10,000	117,600																																																																																																																																																																																																														
Open Space (Year) 0			2012	17,000	110,600	10,000	117,600																																																																																																																																																																																																														
Farmland (Year) 0			2013	17,000	110,600	10,000	117,600																																																																																																																																																																																																														
Zone/Land Use 11 Rur Agricultural			2014	17,000	110,600	10,000	117,600																																																																																																																																																																																																														
Secondary Zone			2015	17,000	110,600	10,000	117,600																																																																																																																																																																																																														
Topography 3 Above Street			2016	17,000	110,600	16,500	111,100																																																																																																																																																																																																														
1.Level 4.Below St 7.			2017	17,000	110,600	0	127,600																																																																																																																																																																																																														
2.Rolling 5.Low 8.			2018	17,000	110,600	0	127,600																																																																																																																																																																																																														
3.Above St 6.Swampy 9.			2019	17,000	110,600	0	127,600																																																																																																																																																																																																														
Utilities 4 Drilled Well 6 Septic System			2020	17,000	110,600	0	127,600																																																																																																																																																																																																														
1.Public 4.Dr Well 7.Cesspool			2021	17,000	110,600	0	127,600																																																																																																																																																																																																														
2.Water 5.Dug Well 8.Lake Water			2022	17,000	110,600	22,000	105,600																																																																																																																																																																																																														
3.Sewer 6.Septic 9.None			2023	17,000	110,600	19,250	108,350																																																																																																																																																																																																														
Street 1 Paved			2024	34,300	247,600	25,000	256,900																																																																																																																																																																																																														
1.Paved 4.Proposed 7.			<table border="1"> <thead> <tr> <th colspan="6">Land Data</th> </tr> <tr> <th rowspan="2">Front Foot</th> <th rowspan="2">Type</th> <th colspan="2">Effective</th> <th colspan="2">Influence</th> <th rowspan="2">Influence Codes</th> </tr> <tr> <th>Frontage</th> <th>Depth</th> <th>Factor</th> <th>Code</th> </tr> </thead> <tbody> <tr> <td>11.Commercial Lot</td> <td></td> <td></td> <td></td> <td>%</td> <td></td> <td>1.Open Space Red</td> </tr> <tr> <td>12.Not Used</td> <td></td> <td></td> <td></td> <td>%</td> <td></td> <td>2.Excess Frtg</td> </tr> <tr> <td>13.Commercial Lot</td> <td></td> <td></td> <td></td> <td>%</td> <td></td> <td>3.Topography</td> </tr> <tr> <td>14.Not Used</td> <td></td> <td></td> <td></td> <td>%</td> <td></td> <td>4.Size/Shape</td> </tr> <tr> <td>15.Miscellaneous</td> <td></td> <td></td> <td></td> <td>%</td> <td></td> <td>5.Access</td> </tr> <tr> <td></td> <td></td> <td></td> <td></td> <td>%</td> <td></td> <td>6.Restriction</td> </tr> <tr> <td></td> <td></td> <td></td> <td></td> <td>%</td> <td></td> <td>7.Corner Infl</td> </tr> <tr> <td></td> <td></td> <td></td> <td></td> <td>%</td> <td></td> <td>8.View/Environ</td> </tr> <tr> <td></td> <td></td> <td></td> <td></td> <td>%</td> <td></td> <td>9.Fract Share</td> </tr> <tr> <td></td> <td></td> <td></td> <td></td> <td>%</td> <td></td> <td>Acres</td> </tr> <tr> <td></td> <td></td> <td></td> <td></td> <td>%</td> <td></td> <td>30.Prime Lot</td> </tr> <tr> <td></td> <td></td> <td></td> <td></td> <td>%</td> <td></td> <td>31.Blueberry/Hort</td> </tr> <tr> <td></td> <td></td> <td></td> <td></td> <td>%</td> <td></td> <td>32.Pasture</td> </tr> <tr> <td></td> <td></td> <td></td> <td></td> <td>%</td> <td></td> <td>33.Orchard</td> </tr> <tr> <td></td> <td></td> <td></td> <td></td> <td>%</td> <td></td> <td>34.Software(Farm</td> </tr> <tr> <td></td> <td></td> <td></td> <td></td> <td>%</td> <td></td> <td>35.Mixed Wood (Fa</td> </tr> <tr> <td></td> <td></td> <td></td> <td></td> <td>%</td> <td></td> <td>36.Hardwood (Farm</td> </tr> <tr> <td></td> <td></td> <td></td> <td></td> <td>%</td> <td></td> <td>37.Software</td> </tr> <tr> <td></td> <td></td> <td></td> <td></td> <td>%</td> <td></td> <td>38.Mixed Wood</td> </tr> <tr> <td></td> <td></td> <td></td> <td></td> <td>%</td> <td></td> <td>39.Hardwood</td> </tr> <tr> <td></td> <td></td> <td></td> <td></td> <td>%</td> <td></td> <td>40.Wasteland</td> </tr> <tr> <td></td> <td></td> <td></td> <td></td> <td>%</td> <td></td> <td>41.Miscellaneous</td> </tr> <tr> <td></td> <td></td> <td></td> <td></td> <td>%</td> <td></td> <td>42.Mobile Home Si</td> </tr> <tr> <td></td> <td></td> <td></td> <td></td> <td>%</td> <td></td> <td>43.Condo Site</td> </tr> <tr> <td></td> <td></td> <td></td> <td></td> <td>%</td> <td></td> <td>44.Lot Improvemen</td> </tr> <tr> <td></td> <td></td> <td></td> <td></td> <td>%</td> <td></td> <td>45.Utility Valuat</td> </tr> <tr> <td></td> <td></td> <td></td> <td></td> <td>%</td> <td></td> <td>46.Miscellaneous</td> </tr> </tbody> </table>					Land Data						Front Foot	Type	Effective		Influence		Influence Codes	Frontage	Depth	Factor	Code	11.Commercial Lot				%		1.Open Space Red	12.Not Used				%		2.Excess Frtg	13.Commercial Lot				%		3.Topography	14.Not Used				%		4.Size/Shape	15.Miscellaneous				%		5.Access					%		6.Restriction					%		7.Corner Infl					%		8.View/Environ					%		9.Fract Share					%		Acres					%		30.Prime Lot					%		31.Blueberry/Hort					%		32.Pasture					%		33.Orchard					%		34.Software(Farm					%		35.Mixed Wood (Fa					%		36.Hardwood (Farm					%		37.Software					%		38.Mixed Wood					%		39.Hardwood					%		40.Wasteland					%		41.Miscellaneous					%		42.Mobile Home Si					%		43.Condo Site					%		44.Lot Improvemen					%		45.Utility Valuat					%		46.Miscellaneous
Land Data																																																																																																																																																																																																																					
Front Foot	Type	Effective						Influence		Influence Codes																																																																																																																																																																																																											
		Frontage						Depth	Factor		Code																																																																																																																																																																																																										
11.Commercial Lot				%		1.Open Space Red																																																																																																																																																																																																															
12.Not Used				%		2.Excess Frtg																																																																																																																																																																																																															
13.Commercial Lot				%		3.Topography																																																																																																																																																																																																															
14.Not Used				%		4.Size/Shape																																																																																																																																																																																																															
15.Miscellaneous				%		5.Access																																																																																																																																																																																																															
				%		6.Restriction																																																																																																																																																																																																															
				%		7.Corner Infl																																																																																																																																																																																																															
				%		8.View/Environ																																																																																																																																																																																																															
				%		9.Fract Share																																																																																																																																																																																																															
				%		Acres																																																																																																																																																																																																															
				%		30.Prime Lot																																																																																																																																																																																																															
				%		31.Blueberry/Hort																																																																																																																																																																																																															
				%		32.Pasture																																																																																																																																																																																																															
				%		33.Orchard																																																																																																																																																																																																															
				%		34.Software(Farm																																																																																																																																																																																																															
				%		35.Mixed Wood (Fa																																																																																																																																																																																																															
				%		36.Hardwood (Farm																																																																																																																																																																																																															
				%		37.Software																																																																																																																																																																																																															
				%		38.Mixed Wood																																																																																																																																																																																																															
				%		39.Hardwood																																																																																																																																																																																																															
				%		40.Wasteland																																																																																																																																																																																																															
				%		41.Miscellaneous																																																																																																																																																																																																															
				%		42.Mobile Home Si																																																																																																																																																																																																															
				%		43.Condo Site																																																																																																																																																																																																															
				%		44.Lot Improvemen																																																																																																																																																																																																															
				%		45.Utility Valuat																																																																																																																																																																																																															
				%		46.Miscellaneous																																																																																																																																																																																																															
INSPECTION CODE 0			Front Foot																																																																																																																																																																																																																		
PRINT CARD 0			Square Foot																																																																																																																																																																																																																		
Sale Data			Fract. Acre																																																																																																																																																																																																																		
Sale Date 7/08/2016			21.Residential Lo																																																																																																																																																																																																																		
Price 121,999			22.Not Used																																																																																																																																																																																																																		
Sale Type 2 Land & Buildings			23.Waterfront Lot																																																																																																																																																																																																																		
1.Land 4.Mobile 7.			Acres																																																																																																																																																																																																																		
2.L & B 5.Other 8.			24.Not Used																																																																																																																																																																																																																		
3.Building 6. 9.			25.Excess Land (1																																																																																																																																																																																																																		
Financing 9 Unknown			26.Excess Land (1																																																																																																																																																																																																																		
1.Convent 4.Seller 7.			27.Excess Land (>																																																																																																																																																																																																																		
2.FHA/VA 5.Private 8.			28.Excess Land WF																																																																																																																																																																																																																		
3.Assumed 6.Cash 9.Unknown			29.Not Used																																																																																																																																																																																																																		
Validity 1 Arms Length Sale			Total Acreage 1.50																																																																																																																																																																																																																		
1.Valid 4.Split 7.Renovate																																																																																																																																																																																																																					
2.Related 5.Partial 8.Other																																																																																																																																																																																																																					
3.Distress 6.Exempt 9.Trust																																																																																																																																																																																																																					
Verified 5 Public Record																																																																																																																																																																																																																					
1.Buyer 4.Agent 7.Family																																																																																																																																																																																																																					
2.Seller 5.Pub Rec 8.Other																																																																																																																																																																																																																					
3.Lender 6.MLS 9.																																																																																																																																																																																																																					

Windsor

Map Lot 10-024

Account 482

Location 529 WEEKS MILLS ROAD

Card 1 Of 1 10/25/2024

Building Style 1 Conventional	SF Bsmt Living 0	Layout 1 Typical
1.Conv. 5.Garrison 9.Other	Fin Bsmt Grade 0 0	1.Typical 4. 7.
2.Ranch 6.Split 10.Cottage	Secondary heat 0	2.Inadeq 5. 8.
3.R Ranch 7.Contemp 11.Mobile	Heat Type 100% 1 Forced Hot Water	3. 6. 9.
4.Cape 8.Log 12.Gar/Apt	1.HW 5.FWA 9.No Heat	Attic 9 None
Dwelling Units 1	2.HWCI 6.GravWA 10.Radiant	1.1/4 Fin 4.Full Fin 7.
Other Units 0	3.H Pump 7.Electric 11.	2.1/2 Fin 5.FI/Stair 8.
Stories 5 One & 3/4 Story	4.Steam 8.Monitor/ 12.	3.3/4 Fin 6. 9.None
1.1 4.1.5 7.	Cool Type 0% 9 None	Insulation 1 TYPICAL
2.2 5.1.75 8.	1.Refrig 4.W&C Air 7.	1.Full 4.Minimal 7.
3.3 6.2.5 9.	2.Evapor 5. 8.	2.Heavy 5. 8.
Exterior Walls 2 Vinyl/Aluminum	3.H Pump 6. 9.None	3.Capped 6. 9.None
1.Wood 5.Stucco 9.Other	Kitchen Style 2 Typical	Unfinished % 0%
2.Vin/Al 6.Brick 10.Cement	1.Modern 4.Obsolete 7.	Grade & Factor 3 Average 100%
3.Compos. 7.Stone 11.	2.Typical 5. 8.	1.E Grade 4.B Grade 7.
4.Asbestos 8.Concrete 12.	3.Old Type 6. 9.None	2.D Grade 5.A Grade 8.SC Grade
Roof Surface 1 Asphalt Shingles	Bath(s) Style 2 Typical Bath(s)	3.C Grade 6.AA Grade 9.Same
1.Asphalt 4.Composit 7.SS	1.Modern 4.Obsolete 7.	SOQT (Footprint) 400
2.Slate 5.Wood 8.	2.Typical 5. 8.	Condition 5 Above Average
3.Metal 6.Other 9.	3.Old Type 6. 9.None	1.Poor 4.Avg 7.V G
SF Masonry Trim 0	# Rooms 7	2.Fair 5.Avg+ 8.Exc
OPEN-3-CUSTOM 0	# Bedrooms 3	3.Avg- 6.Good 9.Same
OPEN-4-CUSTOM 0	# Full Baths 1	Phys. % Good 0%
Year Built 1950	# Half Baths 0	Funct. % Good 100%
Year Remodeled 1986	# Addn Fixtures 0	Functional Code 9 None
Foundation 1 Concrete	# Fireplaces 0	1.Incomp 4.Long Ter 7.Damage
1.Concrete 4.Wood 7.		2.O-Built 5.Dilapida 8.Basement
2.C Block 5.Slab 8.		3.MoHoNoLa 6.Util/Lay 9.None
3.Br/Stone 6.Piers 9.		Econ. % Good 100%
Basement 3 3/4 Basement		Economic Code None
1.1/4 Bmt 4.Full Bmt 7.		0.None 9.None 7.
2.1/2 Bmt 5.Crawl Sp 8.		1.Location 5. 8.
3.3/4 Bmt 6. 9.None		2.Encroach 6. 9.
Bsmt Gar # Cars 0		Entrance Code 5 Estimated
Wet Basement 3 Wet Basement		1.Interior 4.Vacant 7.
1.Dry 4. 7.		2.Refusal 5.Estimate 8.
2.Damp 5. 8.	3.Informed 6. 9.	
3.Wet 6. 9.	Information Code 5 Estimate	
	1.Owner 4.Agent 7.	
	2.Relative 5.Estimate 8.	
	3.Tenant 6.Other 9.	

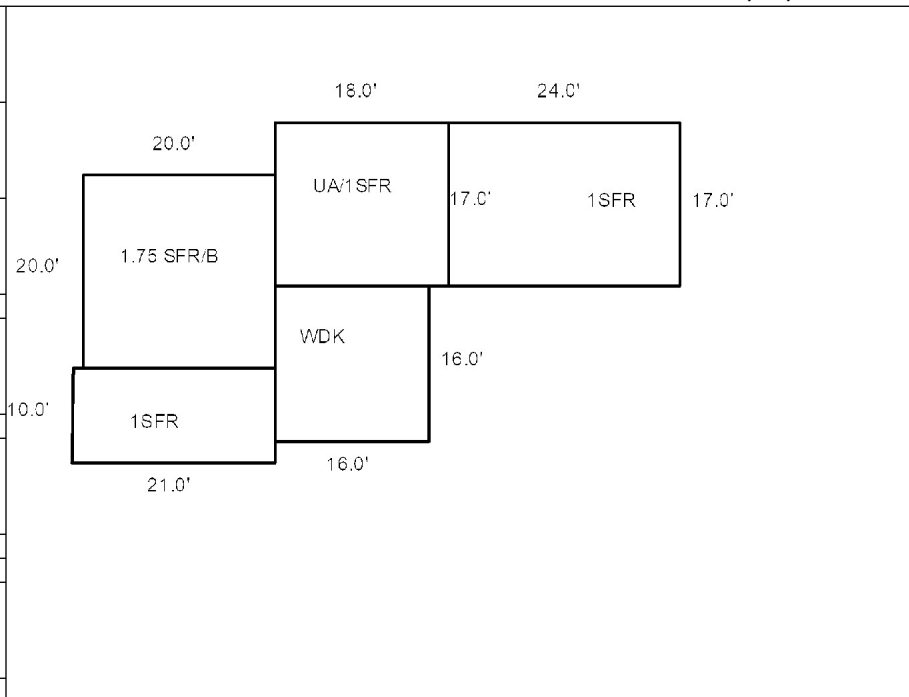

Date Inspected 7/24/2024

Additions, Outbuildings & Improvements

Type	Year	Units	Grade	Cond	Phys.	Funct.	Sound Value
1 1 Story Frame	1990	408	3 100	5	0 %	100 %	
1 1 Story Frame	1990	210	3 100	5	0 %	100 %	
68 Wood Deck	1990	256	3 100	3	0 %	100 %	
23 Frame Garage	1990	384	2 100	2	0 %	100 %	
23 Frame Garage	1990	432	2 100	2	0 %	100 %	
9 Unfin Attic/1 Sty	1980	306	3 100	5	0 %	100 %	
24 Frame Shed	1990	36	3 100	3	0 %	100 %	
24 Frame Shed	1990	49	2 100	3	0 %	100 %	
					%	%	
					%	%	



1.1 Story Frame	2.2 Story Frame	3.3 Story Frame	4.1-1/2 Story Fr	5.1-3/4 Story Fr	6.2-1/2 Story Fr	21.Open Frame Por	22.Encl Frame Por	23.Frame Garage	24.Frame Shed	25.Frame Bay Wind	26.1SFr Overhang	27.Unfin Basement	28.Unfinished Att	29.Finished Attic
-----------------	-----------------	-----------------	------------------	------------------	------------------	-------------------	-------------------	-----------------	---------------	-------------------	------------------	-------------------	-------------------	-------------------