

Windsor

Map Lot 04-028

Account 139

Location 153 BARTON ROAD

Card 1 Of 1 10/23/2024

Building Style 2 Ranch	SF Bsmt Living 0	Layout 1 Typical
1.Conv. 5.Garrison 9.Other	Fin Bsmt Grade 0 0	1.Typical 4. 7.
2.Ranch 6.Split 10.Cottage	Secondary heat 0	2.Inadeq 5. 8.
3.R Ranch 7.Contemp 11.Mobile	Heat Type 100% 1 Forced Hot Water	3. 6. 9.
4.Cape 8.Log 12.Gar/Apt	1.HW 5.FWA 9.No Heat	Attic 9 None
Dwelling Units 1	2.HWCI 6.GravWA 10.Radiant	1.1/4 Fin 4.Full Fin 7.
Other Units 0	3.H Pump 7.Electric 11.	2.1/2 Fin 5.FI/Stair 8.
Stories 1 One Story	4.Steam 8.Monitor/ 12.	3.3/4 Fin 6. 9.None
1.1 4.1.5 7.	Cool Type 100% 3 Heat Pump	Insulation 1 TYPICAL
2.2 5.1.75 8.	1.Refrig 4.W&C Air 7.	1.Full 4.Minimal 7.
3.3 6.2.5 9.	2.Evapor 5. 8.	2.Heavy 5. 8.
Exterior Walls 2 Vinyl/Aluminum	3.H Pump 6. 9.None	3.Capped 6. 9.None
1.Wood 5.Stucco 9.Other	Kitchen Style 2 Typical	Unfinished % 0%
2.Vin/Al 6.Brick 10.Cement	1.Modern 4.Obsolete 7.	Grade & Factor 3 Average 100%
3.Compos. 7.Stone 11.	2.Typical 5. 8.	1.E Grade 4.B Grade 7.
4.Asbestos 8.Concrete 12.	3.Old Type 6. 9.None	2.D Grade 5.A Grade 8.SC Grade
Roof Surface 3 Sheet Metal	Bath(s) Style 2 Typical Bath(s)	3.C Grade 6.AA Grade 9.Same
1.Asphalt 4.Composit 7.SS	1.Modern 4.Obsolete 7.	SQFT (Footprint) 816
2.Slate 5.Wood 8.	2.Typical 5. 8.	Condition 5 Above Average
3.Metal 6.Other 9.	3.Old Type 6. 9.None	1.Poor 4.Avg 7.V G
SF Masonry Trim 0	# Rooms 6	2.Fair 5.Avg+ 8.Exc
OPEN-3-CUSTOM 0	# Bedrooms 3	3.Avg- 6.Good 9.Same
OPEN-4-CUSTOM 0	# Full Baths 2	Phys. % Good 0%
Year Built 1975	# Half Baths 0	Funct. % Good 100%
Year Remodeled 2017	# Addn Fixtures 0	Functional Code 9 None
Foundation 1 Concrete	# Fireplaces 0	1.Incomp 4.Long Ter 7.Damage
1.Concrete 4.Wood 7.		2.O-Built 5.Dilapida 8.Basement
2.C Block 5.Slab 8.		3.MoHoNoLa 6.Util/Lay 9.None
3.Br/Stone 6.Piers 9.		Econ. % Good 100%
Basement 4 Full Basement		Economic Code None
1.1/4 Bmt 4.Full Bmt 7.		0.None 9.None 7.
2.1/2 Bmt 5.Crawl Sp 8.		1.Location 5. 8.
3.3/4 Bmt 6. 9.None		2.Encroach 6. 9.
Bsmt Gar # Cars 0		Entrance Code 5 Estimated
Wet Basement 1 Dry Basement		1.Interior 4.Vacant 7.
1.Dry 4. 7.		2.Refusal 5.Estimate 8.
2.Damp 5. 8.	3.Informed 6. 9.	
3.Wet 6. 9.	Information Code 5 Estimate	
	1.Owner 4.Agent 7.	
	2.Relative 5.Estimate 8.	
	3.Tenant 6.Other 9.	

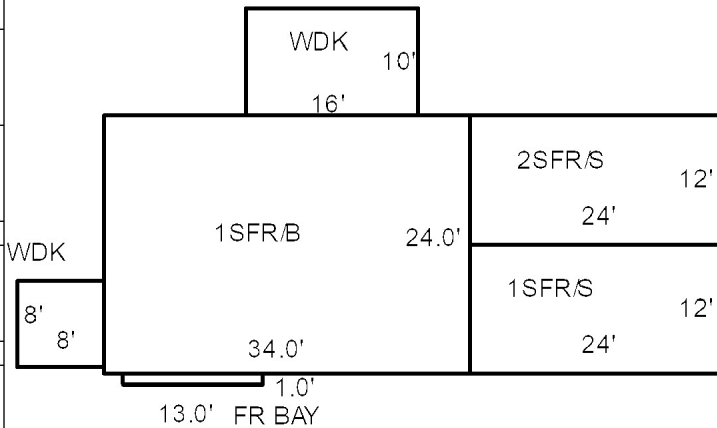

Date Inspected 7/26/2024

Additions, Outbuildings & Improvements

Type	Year	Units	Grade	Cond	Phys.	Funct.	Sound Value
2 2 Story Frame	1985	288	3 100	4	0 %	100 %	
25 Frame Bay	1985	13	3 100	4	0 %	100 %	
68 Wood Deck	2017	160	3 100	4	0 %	100 %	
68 Wood Deck	2017	64	3 100	4	0 %	100 %	
1 1 Story Frame	2017	288	3 100	4	0 %	100 %	
44 2S Frame Shed	2017	384	2 100	2	0 %	100 %	
24 Frame Shed	2017	50	2 100	3	0 %	100 %	
73 Above ground	2024	1	3 100	4	0 %	100 %	
69 Hot Tub	2024	1	3 100	4	0 %	100 %	
					%	%	

