

HUSSEY'S GENERAL STORE
 P.O. BOX 81
 WINDSOR ME 04363

B8516P255 B8516P258

Previous Owner
 WINDSOR, TOWN OF

WINDSOR ME 04363
 Sale Date: 12/19/2005

Inspection Witnessed By:

X	Date	Date Insp.
No./Date	Description	Date Insp.

Notes:
 7/24 KL FR

Windsor

Property Data			Assessment Record																																																																																																																																																																																																																
Neighborhood 4 Nbhd 4			Year	Land	Buildings	Exempt	Total																																																																																																																																																																																																												
Tree Growth Year 0			2011	20,100	64,700	0	84,800																																																																																																																																																																																																												
Open Space (Year) 0			2012	20,100	64,700	0	84,800																																																																																																																																																																																																												
Farmland (Year) 0			2013	20,100	64,700	0	84,800																																																																																																																																																																																																												
Zone/Land Use 11 Rur Agricultural			2014	20,100	64,700	0	84,800																																																																																																																																																																																																												
Secondary Zone			2015	20,100	64,700	0	84,800																																																																																																																																																																																																												
Topography 1 Level			2016	20,100	64,700	0	84,800																																																																																																																																																																																																												
1.Level 4.Below St 7.			2017	20,100	64,700	0	84,800																																																																																																																																																																																																												
2.Rolling 5.Low 8.			2018	20,100	64,700	0	84,800																																																																																																																																																																																																												
3.Above St 6.Swampy 9.			2019	20,100	64,700	0	84,800																																																																																																																																																																																																												
Utilities 4 Drilled Well 6 Septic System			2020	20,100	64,700	0	84,800																																																																																																																																																																																																												
1.Public 4.Dr Well 7.Cesspool			2021	20,100	64,700	0	84,800																																																																																																																																																																																																												
2.Water 5.Dug Well 8.Lake Water			2022	20,100	64,700	0	84,800																																																																																																																																																																																																												
3.Sewer 6.Septic 9.None			2023	20,100	64,700	0	84,800																																																																																																																																																																																																												
Street 1 Paved			2024	23,300	88,200	0	111,500																																																																																																																																																																																																												
1.Paved 4.Proposed 7.			<table border="1"> <thead> <tr> <th colspan="4">Land Data</th> </tr> <tr> <th rowspan="2">Front Foot</th> <th rowspan="2">Type</th> <th colspan="2">Effective</th> <th colspan="2">Influence</th> <th rowspan="2">Influence Codes</th> </tr> <tr> <th>Frontage</th> <th>Depth</th> <th>Factor</th> <th>Code</th> </tr> </thead> <tbody> <tr> <td>11.Commercial Lot</td> <td></td> <td></td> <td></td> <td>%</td> <td></td> <td>1.Open Space Red</td> </tr> <tr> <td>12.Not Used</td> <td></td> <td></td> <td></td> <td>%</td> <td></td> <td>2.Excess Frtg</td> </tr> <tr> <td>13.Commercial Lot</td> <td></td> <td></td> <td></td> <td>%</td> <td></td> <td>3.Topography</td> </tr> <tr> <td>14.Not Used</td> <td></td> <td></td> <td></td> <td>%</td> <td></td> <td>4.Size/Shape</td> </tr> <tr> <td>15.Miscellaneous</td> <td></td> <td></td> <td></td> <td>%</td> <td></td> <td>5.Access</td> </tr> <tr> <td></td> <td></td> <td></td> <td></td> <td>%</td> <td></td> <td>6.Restriction</td> </tr> <tr> <td></td> <td></td> <td></td> <td></td> <td>%</td> <td></td> <td>7.Corner Infl</td> </tr> <tr> <td></td> <td></td> <td></td> <td></td> <td>%</td> <td></td> <td>8.View/Environ</td> </tr> <tr> <td></td> <td></td> <td></td> <td></td> <td>%</td> <td></td> <td>9.Fract Share</td> </tr> <tr> <td></td> <td></td> <td></td> <td></td> <td>%</td> <td></td> <td>Acres</td> </tr> <tr> <td></td> <td></td> <td></td> <td></td> <td>%</td> <td></td> <td>30.Prime Lot</td> </tr> <tr> <td></td> <td></td> <td></td> <td></td> <td>%</td> <td></td> <td>31.Blueberry/Hort</td> </tr> <tr> <td></td> <td></td> <td></td> <td></td> <td>%</td> <td></td> <td>32.Pasture</td> </tr> <tr> <td></td> <td></td> <td></td> <td></td> <td>%</td> <td></td> <td>33.Orchard</td> </tr> <tr> <td></td> <td></td> <td></td> <td></td> <td>%</td> <td></td> <td>34.Softwood(Farm</td> </tr> <tr> <td></td> <td></td> <td></td> <td></td> <td>%</td> <td></td> <td>35.Mixed Wood (Fa</td> </tr> <tr> <td></td> <td>11</td> <td>0.07</td> <td>75</td> <td>%</td> <td>4</td> <td>36.Hardwood (Farm</td> </tr> <tr> <td></td> <td>12</td> <td>1.00</td> <td>100</td> <td>%</td> <td>0</td> <td>37.Softwood</td> </tr> <tr> <td></td> <td></td> <td></td> <td></td> <td>%</td> <td></td> <td>38.Mixed Wood</td> </tr> <tr> <td></td> <td></td> <td></td> <td></td> <td>%</td> <td></td> <td>39.Hardwood</td> </tr> <tr> <td></td> <td></td> <td></td> <td></td> <td>%</td> <td></td> <td>40.Wasteland</td> </tr> <tr> <td></td> <td></td> <td></td> <td></td> <td>%</td> <td></td> <td>41.Miscellaneous</td> </tr> <tr> <td></td> <td></td> <td></td> <td></td> <td>%</td> <td></td> <td>42.Mobile Home Si</td> </tr> <tr> <td></td> <td></td> <td></td> <td></td> <td>%</td> <td></td> <td>43.Condo Site</td> </tr> <tr> <td></td> <td></td> <td></td> <td></td> <td>%</td> <td></td> <td>44.Lot Improvemen</td> </tr> <tr> <td></td> <td></td> <td></td> <td></td> <td>%</td> <td></td> <td>45.Utility Valuat</td> </tr> <tr> <td></td> <td></td> <td></td> <td></td> <td>%</td> <td></td> <td>46.Miscellaneous</td> </tr> </tbody> </table>					Land Data				Front Foot	Type	Effective		Influence		Influence Codes	Frontage	Depth	Factor	Code	11.Commercial Lot				%		1.Open Space Red	12.Not Used				%		2.Excess Frtg	13.Commercial Lot				%		3.Topography	14.Not Used				%		4.Size/Shape	15.Miscellaneous				%		5.Access					%		6.Restriction					%		7.Corner Infl					%		8.View/Environ					%		9.Fract Share					%		Acres					%		30.Prime Lot					%		31.Blueberry/Hort					%		32.Pasture					%		33.Orchard					%		34.Softwood(Farm					%		35.Mixed Wood (Fa		11	0.07	75	%	4	36.Hardwood (Farm		12	1.00	100	%	0	37.Softwood					%		38.Mixed Wood					%		39.Hardwood					%		40.Wasteland					%		41.Miscellaneous					%		42.Mobile Home Si					%		43.Condo Site					%		44.Lot Improvemen					%		45.Utility Valuat					%		46.Miscellaneous
Land Data																																																																																																																																																																																																																			
Front Foot	Type	Effective						Influence		Influence Codes																																																																																																																																																																																																									
		Frontage						Depth	Factor		Code																																																																																																																																																																																																								
11.Commercial Lot									%		1.Open Space Red																																																																																																																																																																																																								
12.Not Used				%		2.Excess Frtg																																																																																																																																																																																																													
13.Commercial Lot				%		3.Topography																																																																																																																																																																																																													
14.Not Used				%		4.Size/Shape																																																																																																																																																																																																													
15.Miscellaneous				%		5.Access																																																																																																																																																																																																													
				%		6.Restriction																																																																																																																																																																																																													
				%		7.Corner Infl																																																																																																																																																																																																													
				%		8.View/Environ																																																																																																																																																																																																													
				%		9.Fract Share																																																																																																																																																																																																													
				%		Acres																																																																																																																																																																																																													
				%		30.Prime Lot																																																																																																																																																																																																													
				%		31.Blueberry/Hort																																																																																																																																																																																																													
				%		32.Pasture																																																																																																																																																																																																													
				%		33.Orchard																																																																																																																																																																																																													
				%		34.Softwood(Farm																																																																																																																																																																																																													
				%		35.Mixed Wood (Fa																																																																																																																																																																																																													
	11	0.07	75	%	4	36.Hardwood (Farm																																																																																																																																																																																																													
	12	1.00	100	%	0	37.Softwood																																																																																																																																																																																																													
				%		38.Mixed Wood																																																																																																																																																																																																													
				%		39.Hardwood																																																																																																																																																																																																													
				%		40.Wasteland																																																																																																																																																																																																													
				%		41.Miscellaneous																																																																																																																																																																																																													
				%		42.Mobile Home Si																																																																																																																																																																																																													
				%		43.Condo Site																																																																																																																																																																																																													
				%		44.Lot Improvemen																																																																																																																																																																																																													
				%		45.Utility Valuat																																																																																																																																																																																																													
				%		46.Miscellaneous																																																																																																																																																																																																													
INSPECTION CODE 0			<table border="1"> <thead> <tr> <th colspan="3">Square Foot</th> <th colspan="3">Acres/Sites</th> </tr> </thead> <tbody> <tr> <td colspan="3">16.Gravel Pit Sit</td> <td colspan="3"></td> </tr> <tr> <td colspan="3">17.Gravel Pit Pot</td> <td colspan="3"></td> </tr> <tr> <td colspan="3">18.Excess Land</td> <td colspan="3"></td> </tr> <tr> <td colspan="3">19.Condominium</td> <td colspan="3"></td> </tr> <tr> <td colspan="3">20.Miscellaneous</td> <td colspan="3"></td> </tr> <tr> <td colspan="3">Fract. Acre</td> <td colspan="3"></td> </tr> <tr> <td colspan="3">21.Residential Lo</td> <td colspan="3"></td> </tr> <tr> <td colspan="3">22.Not Used</td> <td colspan="3"></td> </tr> <tr> <td colspan="3">23.Waterfront Lot</td> <td colspan="3"></td> </tr> <tr> <td colspan="3">Acres</td> <td colspan="3"></td> </tr> <tr> <td colspan="3">24.Not Used</td> <td colspan="3"></td> </tr> <tr> <td colspan="3">25.Excess Land (1</td> <td colspan="3"></td> </tr> <tr> <td colspan="3">26.Excess Land (1</td> <td colspan="3"></td> </tr> <tr> <td colspan="3">27.Excess Land (></td> <td colspan="3"></td> </tr> <tr> <td colspan="3">28.Excess Land WF</td> <td colspan="3"></td> </tr> <tr> <td colspan="3">29.Not Used</td> <td colspan="3"></td> </tr> </tbody> </table>					Square Foot			Acres/Sites			16.Gravel Pit Sit						17.Gravel Pit Pot						18.Excess Land						19.Condominium						20.Miscellaneous						Fract. Acre						21.Residential Lo						22.Not Used						23.Waterfront Lot						Acres						24.Not Used						25.Excess Land (1						26.Excess Land (1						27.Excess Land (>						28.Excess Land WF						29.Not Used																																																																																																											
Square Foot								Acres/Sites																																																																																																																																																																																																											
16.Gravel Pit Sit																																																																																																																																																																																																																			
17.Gravel Pit Pot																																																																																																																																																																																																																			
18.Excess Land																																																																																																																																																																																																																			
19.Condominium																																																																																																																																																																																																																			
20.Miscellaneous																																																																																																																																																																																																																			
Fract. Acre																																																																																																																																																																																																																			
21.Residential Lo																																																																																																																																																																																																																			
22.Not Used																																																																																																																																																																																																																			
23.Waterfront Lot																																																																																																																																																																																																																			
Acres																																																																																																																																																																																																																			
24.Not Used																																																																																																																																																																																																																			
25.Excess Land (1																																																																																																																																																																																																																			
26.Excess Land (1																																																																																																																																																																																																																			
27.Excess Land (>																																																																																																																																																																																																																			
28.Excess Land WF																																																																																																																																																																																																																			
29.Not Used																																																																																																																																																																																																																			
PRINT CARD 0			<table border="1"> <thead> <tr> <th colspan="2">Sale Data</th> </tr> </thead> <tbody> <tr> <td>Sale Date</td> <td></td> </tr> <tr> <td>Price</td> <td></td> </tr> <tr> <td>Sale Type</td> <td></td> </tr> <tr> <td>1.Land 4.Mobile 7.</td> <td></td> </tr> <tr> <td>2.L & B 5.Other 8.</td> <td></td> </tr> <tr> <td>3.Building 6. 9.</td> <td></td> </tr> <tr> <td>Financing</td> <td></td> </tr> <tr> <td>1.Convent 4.Seller 7.</td> <td></td> </tr> <tr> <td>2.FHA/VA 5.Private 8.</td> <td></td> </tr> <tr> <td>3.Assumed 6.Cash 9.Unknown</td> <td></td> </tr> <tr> <td>Validity</td> <td></td> </tr> <tr> <td>1.Valid 4.Split 7.Renovate</td> <td></td> </tr> <tr> <td>2.Related 5.Partial 8.Other</td> <td></td> </tr> <tr> <td>3.Distress 6.Exempt 9.Trust</td> <td></td> </tr> <tr> <td>Verified</td> <td></td> </tr> <tr> <td>1.Buyer 4.Agent 7.Family</td> <td></td> </tr> <tr> <td>2.Seller 5.Pub Rec 8.Other</td> <td></td> </tr> <tr> <td>3.Lender 6.MLS 9.</td> <td></td> </tr> </tbody> </table>					Sale Data		Sale Date		Price		Sale Type		1.Land 4.Mobile 7.		2.L & B 5.Other 8.		3.Building 6. 9.		Financing		1.Convent 4.Seller 7.		2.FHA/VA 5.Private 8.		3.Assumed 6.Cash 9.Unknown		Validity		1.Valid 4.Split 7.Renovate		2.Related 5.Partial 8.Other		3.Distress 6.Exempt 9.Trust		Verified		1.Buyer 4.Agent 7.Family		2.Seller 5.Pub Rec 8.Other		3.Lender 6.MLS 9.																																																																																																																																																																							
Sale Data																																																																																																																																																																																																																			
Sale Date																																																																																																																																																																																																																			
Price																																																																																																																																																																																																																			
Sale Type																																																																																																																																																																																																																			
1.Land 4.Mobile 7.																																																																																																																																																																																																																			
2.L & B 5.Other 8.																																																																																																																																																																																																																			
3.Building 6. 9.																																																																																																																																																																																																																			
Financing																																																																																																																																																																																																																			
1.Convent 4.Seller 7.																																																																																																																																																																																																																			
2.FHA/VA 5.Private 8.																																																																																																																																																																																																																			
3.Assumed 6.Cash 9.Unknown																																																																																																																																																																																																																			
Validity																																																																																																																																																																																																																			
1.Valid 4.Split 7.Renovate																																																																																																																																																																																																																			
2.Related 5.Partial 8.Other																																																																																																																																																																																																																			
3.Distress 6.Exempt 9.Trust																																																																																																																																																																																																																			
Verified																																																																																																																																																																																																																			
1.Buyer 4.Agent 7.Family																																																																																																																																																																																																																			
2.Seller 5.Pub Rec 8.Other																																																																																																																																																																																																																			
3.Lender 6.MLS 9.																																																																																																																																																																																																																			
Sale Data			<table border="1"> <thead> <tr> <th colspan="2">Total Acreage</th> </tr> </thead> <tbody> <tr> <td>0.07</td> <td></td> </tr> </tbody> </table>					Total Acreage		0.07																																																																																																																																																																																																									
Total Acreage																																																																																																																																																																																																																			
0.07																																																																																																																																																																																																																			

Windsor

Map Lot U2-003

Account 1240

Location 520 RIDGE ROAD

Card 1 Of 1 10/25/2024

Building Style	SF Bsmt Living	Layout
1.Conv. 5.Garrison 9.Other	Fin Bsmt Grade	1.Typical 4. 7.
2.Ranch 6.Split 10.Cottage	Secondary heat	2.Inadeq 5. 8.
3.R Ranch 7.Contemp 11.Mobile	Heat Type 100%	3. 6. 9.
4.Cape 8.Log 12.Gar/Apt	1.HW 5.FWA 9.No Heat	Attic
Dwelling Units	2.HWCI 6.GravWA 10.Radiant	1.1/4 Fin 4.Full Fin 7.
Other Units	3.H Pump 7.Electric 11.	2.1/2 Fin 5.F/Stair 8.
Stories	4.Steam 8.Monitor/ 12.	3.3/4 Fin 6. 9.None
1.1 4.1.5 7.	Cool Type 0%	Insulation
2.2 5.1.75 8.	1.Refrig 4.W&C Air 7.	1.Full 4.Minimal 7.
3.3 6.2.5 9.	2.Evapor 5. 8.	2.Heavy 5. 8.
Exterior Walls	3.H Pump 6. 9.None	3.Capped 6. 9.None
1.Wood 5.Stucco 9.Other	Kitchen Style	Unfinished %
2.Vin/Al 6.Brick 10.Cement	1.Modern 4.Obsolete 7.	Grade & Factor
3.Compos. 7.Stone 11.	2.Typical 5. 8.	1.E Grade 4.B Grade 7.
4.Asbestos 8.Concrete 12.	3.Old Type 6. 9.None	2.D Grade 5.A Grade 8.SC Grade
Roof Surface	Bath(s) Style	3.C Grade 6.AA Grade 9.Same
1.Asphalt 4.Composit 7.SS	1.Modern 4.Obsolete 7.	SQFT (Footprint)
2.Slate 5.Wood 8.	2.Typical 5. 8.	Condition
3.Metal 6.Other 9.	3.Old Type 6. 9.None	1.Poor 4.Avg 7.V G
SF Masonry Trim	# Rooms	2.Fair 5.Avg+ 8.Exc
OPEN-3-CUSTOM	# Bedrooms	3.Avg- 6.Good 9.Same
OPEN-4-CUSTOM	# Full Baths	Phys. % Good
Year Built	# Half Baths	Funct. % Good
Year Remodeled	# Addn Fixtures	Functional Code
Foundation	# Fireplaces	1.Incomp 4.Long Ter 7.Damage
1.Concrete 4.Wood 7.		2.O-Built 5.Dilapida 8.Basement
2.C Block 5.Slab 8.		3.MoHoNoLa 6.Util/Lay 9.None
3.Br/Stone 6.Piers 9.		Econ. % Good
Basement		Economic Code
1.1/4 Bmt 4.Full Bmt 7.		0.None 9.None 7.
2.1/2 Bmt 5.Crawl Sp 8.		1.Location 5. 8.
3.3/4 Bmt 6. 9.None		2.Encroach 6. 9.
Bsmt Gar # Cars		Entrance Code 5 Estimated
Wet Basement		1.Interior 4.Vacant 7.
1.Dry 4. 7.		2.Refusal 5.Estimate 8.
2.Damp 5. 8.	3.Informed 6. 9.	
3.Wet 6. 9.	Information Code 5 Estimate	
	1.Owner 4.Agent 7.	
	2.Relative 5.Estimate 8.	
	3.Tenant 6.Other 9.	

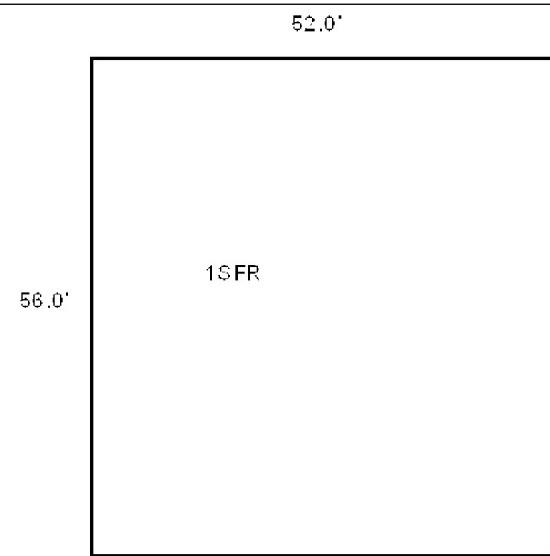

Date Inspected 7/26/2024

Additions, Outbuildings & Improvements								
Type	Year	Units	Grade	Cond	Phys.	Funct.	Sound Value	
370 Pre Eng Garage	1900	2912	3 100	3	0 %	100 %		1.1 Story Frame
385 Office Enclosure	1900	484	3 100	3	0 %	100 %		2.2 Story Frame
					%	%		3.3 Story Frame
					%	%		4.1-1/2 Story Fr
					%	%		5.1-3/4 Story Fr
					%	%		6.2-1/2 Story Fr
					%	%		21.Open Frame Por
					%	%		22.Encl Frame Por
					%	%		23.Frame Garage
					%	%		24.Frame Shed
					%	%		25.Frame Bay Wind
					%	%		26.1SFr Overhang
					%	%		27.Unfin Basement
					%	%		28.Unfinished Att
					%	%		29.Finished Attic