

KESSEL, DANIEL E., SR. & JEAN M.
1 PHANEUF STREET
MIDDLETON MA 01949

B7125P46

Inspection Witnessed By:

X	Date	Date Insp.
No./Date	Description	Date Insp.

Notes:
FOR 4-1-16 INSP. STRUCTURE HAS NO SPETIC, NO WELL.
BUILDING IS SHELL ONLY. JEANNIE KESSEL 978-774-8338.
CALL AFTER WORKUP. 7/18/16 PRIMITVE, ROUGH
STRUCTURE; NO WELL OR SEPTIC; SEASONAL ONLY.
10/23 - DB NO TRESPASS SIGNS, NO PIC DUE TO SIGNS

Windsor

Property Data			Assessment Record																																																																																																																																																																																		
Neighborhood 11 Nbhd 11			Year	Land	Buildings	Exempt	Total																																																																																																																																																																														
Tree Growth Year 0			2011	18,000	28,200	0	46,200																																																																																																																																																																														
Open Space (Year) 0			2012	18,000	28,200	0	46,200																																																																																																																																																																														
Farmland (Year) 0			2013	18,000	28,200	0	46,200																																																																																																																																																																														
Zone/Land Use 11 Rur Agricultural			2014	18,000	28,200	0	46,200																																																																																																																																																																														
Secondary Zone			2015	18,000	28,200	0	46,200																																																																																																																																																																														
Topography 2 Rolling			2016	18,000	9,500	0	27,500																																																																																																																																																																														
1.Level 4.Below St 7.			2017	18,000	9,500	0	27,500																																																																																																																																																																														
2.Rolling 5.Low 8.			2018	18,000	9,500	0	27,500																																																																																																																																																																														
3.Above St 6.Swampy 9.			2019	18,000	9,500	0	27,500																																																																																																																																																																														
Utilities 9 None 9 None			2020	18,000	9,500	0	27,500																																																																																																																																																																														
1.Public 4.Dr Well 7.Cesspool			2021	18,000	9,500	0	27,500																																																																																																																																																																														
2.Water 5.Dug Well 8.Lake Water			2022	18,000	9,500	0	27,500																																																																																																																																																																														
3.Sewer 6.Septic 9.None			2023	18,000	9,500	0	27,500																																																																																																																																																																														
Street 2 Semi-Improved			2024	32,300	64,800	0	97,100																																																																																																																																																																														
1.Paved 4.Proposed 7.			<table border="1"> <thead> <tr> <th colspan="2">Front Foot</th> <th colspan="2">Effective</th> <th colspan="2">Influence</th> <th rowspan="2">Influence Codes</th> </tr> <tr> <th>Type</th> <th>Frontage</th> <th>Depth</th> <th>Factor</th> <th>Code</th> </tr> </thead> <tbody> <tr> <td>11.Commercial Lot</td> <td></td> <td></td> <td>%</td> <td></td> <td>1.Open Space Red</td> </tr> <tr> <td>12.Not Used</td> <td></td> <td></td> <td>%</td> <td></td> <td>2.Excess Frtg</td> </tr> <tr> <td>13.Commercial Lot</td> <td></td> <td></td> <td>%</td> <td></td> <td>3.Topography</td> </tr> <tr> <td>14.Not Used</td> <td></td> <td></td> <td>%</td> <td></td> <td>4.Size/Shape</td> </tr> <tr> <td>15.Miscellaneous</td> <td></td> <td></td> <td>%</td> <td></td> <td>5.Access</td> </tr> <tr> <td></td> <td></td> <td></td> <td>%</td> <td></td> <td>6.Restriction</td> </tr> <tr> <td></td> <td></td> <td></td> <td>%</td> <td></td> <td>7.Corner Infl</td> </tr> <tr> <td></td> <td></td> <td></td> <td>%</td> <td></td> <td>8.View/Environ</td> </tr> <tr> <td></td> <td></td> <td></td> <td>%</td> <td></td> <td>9.Fract Share</td> </tr> <tr> <td></td> <td></td> <td></td> <td>%</td> <td></td> <td>Acres</td> </tr> <tr> <td></td> <td></td> <td></td> <td>%</td> <td></td> <td>30.Prime Lot</td> </tr> <tr> <td></td> <td></td> <td></td> <td>%</td> <td></td> <td>31.Blueberry/Hort</td> </tr> <tr> <td></td> <td></td> <td></td> <td>%</td> <td></td> <td>32.Pasture</td> </tr> <tr> <td></td> <td></td> <td></td> <td>%</td> <td></td> <td>33.Orchard</td> </tr> <tr> <td></td> <td></td> <td></td> <td>%</td> <td></td> <td>34.Software(Farm</td> </tr> <tr> <td></td> <td></td> <td></td> <td>%</td> <td></td> <td>35.Mixed Wood (Fa</td> </tr> <tr> <td></td> <td></td> <td></td> <td>%</td> <td></td> <td>36.Hardwood (Farm</td> </tr> <tr> <td></td> <td>21</td> <td>1.00</td> <td>90 %</td> <td>5</td> <td>37.Software</td> </tr> <tr> <td></td> <td>22</td> <td>1.00</td> <td>90 %</td> <td>5</td> <td>38.Mixed Wood</td> </tr> <tr> <td></td> <td>25</td> <td>1.00</td> <td>100 %</td> <td>0</td> <td>39.Hardwood</td> </tr> <tr> <td></td> <td></td> <td></td> <td>%</td> <td></td> <td>40.Wasteland</td> </tr> <tr> <td></td> <td></td> <td></td> <td>%</td> <td></td> <td>41.Miscellaneous</td> </tr> <tr> <td></td> <td></td> <td></td> <td>%</td> <td></td> <td>42.Mobile Home Si</td> </tr> <tr> <td></td> <td></td> <td></td> <td>%</td> <td></td> <td>43.Condo Site</td> </tr> <tr> <td></td> <td></td> <td></td> <td>%</td> <td></td> <td>44.Lot Improvemen</td> </tr> <tr> <td></td> <td></td> <td></td> <td>%</td> <td></td> <td>45.Utility Valuat</td> </tr> <tr> <td></td> <td></td> <td></td> <td>%</td> <td></td> <td>46.Miscellaneous</td> </tr> </tbody> </table>					Front Foot		Effective		Influence		Influence Codes	Type	Frontage	Depth	Factor	Code	11.Commercial Lot			%		1.Open Space Red	12.Not Used			%		2.Excess Frtg	13.Commercial Lot			%		3.Topography	14.Not Used			%		4.Size/Shape	15.Miscellaneous			%		5.Access				%		6.Restriction				%		7.Corner Infl				%		8.View/Environ				%		9.Fract Share				%		Acres				%		30.Prime Lot				%		31.Blueberry/Hort				%		32.Pasture				%		33.Orchard				%		34.Software(Farm				%		35.Mixed Wood (Fa				%		36.Hardwood (Farm		21	1.00	90 %	5	37.Software		22	1.00	90 %	5	38.Mixed Wood		25	1.00	100 %	0	39.Hardwood				%		40.Wasteland				%		41.Miscellaneous				%		42.Mobile Home Si				%		43.Condo Site				%		44.Lot Improvemen				%		45.Utility Valuat				%		46.Miscellaneous
Front Foot		Effective						Influence		Influence Codes																																																																																																																																																																											
Type	Frontage	Depth	Factor	Code																																																																																																																																																																																	
11.Commercial Lot			%		1.Open Space Red																																																																																																																																																																																
12.Not Used			%		2.Excess Frtg																																																																																																																																																																																
13.Commercial Lot			%		3.Topography																																																																																																																																																																																
14.Not Used			%		4.Size/Shape																																																																																																																																																																																
15.Miscellaneous			%		5.Access																																																																																																																																																																																
			%		6.Restriction																																																																																																																																																																																
			%		7.Corner Infl																																																																																																																																																																																
			%		8.View/Environ																																																																																																																																																																																
			%		9.Fract Share																																																																																																																																																																																
			%		Acres																																																																																																																																																																																
			%		30.Prime Lot																																																																																																																																																																																
			%		31.Blueberry/Hort																																																																																																																																																																																
			%		32.Pasture																																																																																																																																																																																
			%		33.Orchard																																																																																																																																																																																
			%		34.Software(Farm																																																																																																																																																																																
			%		35.Mixed Wood (Fa																																																																																																																																																																																
			%		36.Hardwood (Farm																																																																																																																																																																																
	21	1.00	90 %	5	37.Software																																																																																																																																																																																
	22	1.00	90 %	5	38.Mixed Wood																																																																																																																																																																																
	25	1.00	100 %	0	39.Hardwood																																																																																																																																																																																
			%		40.Wasteland																																																																																																																																																																																
			%		41.Miscellaneous																																																																																																																																																																																
			%		42.Mobile Home Si																																																																																																																																																																																
			%		43.Condo Site																																																																																																																																																																																
			%		44.Lot Improvemen																																																																																																																																																																																
			%		45.Utility Valuat																																																																																																																																																																																
			%		46.Miscellaneous																																																																																																																																																																																
INSPECTION CODE 0			Land Data																																																																																																																																																																																		
PRINT CARD 0																																																																																																																																																																																					
Sale Data																																																																																																																																																																																					
Sale Date																																																																																																																																																																																					
Price																																																																																																																																																																																					
Sale Type																																																																																																																																																																																					
1.Land 4.Mobile 7.			Square Foot																																																																																																																																																																																		
2.L & B 5.Other 8.			Square Feet																																																																																																																																																																																		
3.Building 6. 9.																																																																																																																																																																																					
Financing																																																																																																																																																																																					
1.Convent 4.Seller 7.																																																																																																																																																																																					
2.FHA/VA 5.Private 8.																																																																																																																																																																																					
3.Assumed 6.Cash 9.Unknown																																																																																																																																																																																					
Validity																																																																																																																																																																																					
1.Valid 4.Split 7.Renovate																																																																																																																																																																																					
2.Related 5.Partial 8.Other																																																																																																																																																																																					
3.Distress 6.Exempt 9.Trust																																																																																																																																																																																					
Verified																																																																																																																																																																																					
1.Buyer 4.Agent 7.Family																																																																																																																																																																																					
2.Seller 5.Pub Rec 8.Other																																																																																																																																																																																					
3.Lender 6.MLS 9.																																																																																																																																																																																					
			Fract. Acre																																																																																																																																																																																		
			21.Residential Lo																																																																																																																																																																																		
			22.Not Used																																																																																																																																																																																		
			23.Waterfront Lot																																																																																																																																																																																		
			Acres																																																																																																																																																																																		
			24.Not Used																																																																																																																																																																																		
			25.Excess Land (1																																																																																																																																																																																		
			26.Excess Land (1																																																																																																																																																																																		
			27.Excess Land (>																																																																																																																																																																																		
			28.Excess Land WF																																																																																																																																																																																		
			29.Not Used																																																																																																																																																																																		
			Total Acreage 2.00																																																																																																																																																																																		

Windsor

Map Lot 06-072-B

Account 521

Location 15 DUNTON ROAD

Card 1 Of 1 10/24/2024

Building Style 9 Other	SF Bsmt Living 0	Layout 1 Typical
1.Conv. 5.Garrison 9.Other	Fin Bsmt Grade 0 0	1.Typical 4. 7.
2.Ranch 6.Split 10.Cottage	Secondary heat 0	2.Inadeq 5. 8.
3.R Ranch 7.Contemp 11.Mobile	Heat Type 100% 9 Not Heated	3. 6. 9.
4.Cape 8.Log 12.Gar/Apt	1.HW 5.FWA 9.No Heat	Attic 9 None
Dwelling Units 1	2.HWCI 6.GravWA 10.Radiant	1.1/4 Fin 4.Full Fin 7.
Other Units 0	3.H Pump 7.Electric 11.	2.1/2 Fin 5.FI/Stair 8.
Stories 1 One Story	4.Steam 8.Monitor/ 12.	3.3/4 Fin 6. 9.None
1.1 4.1.5 7.	Cool Type 0% 9 None	Insulation 9 None
2.2 5.1.75 8.	1.Refrig 4.W&C Air 7.	1.Full 4.Minimal 7.
3.3 6.2.5 9.	2.Evapor 5. 8.	2.Heavy 5. 8.
Exterior Walls 1 Wood Siding	3.H Pump 6. 9.None	3.Capped 6. 9.None
1.Wood 5.Stucco 9.Other	Kitchen Style 9 None	Unfinished % 0%
2.Vin/Al 6.Brick 10.Cement	1.Modern 4.Obsolete 7.	Grade & Factor 2 Fair 100%
3.Compos. 7.Stone 11.	2.Typical 5. 8.	1.E Grade 4.B Grade 7.
4.Asbestos 8.Concrete 12.	3.Old Type 6. 9.None	2.D Grade 5.A Grade 8.SC Grade
Roof Surface 1 Asphalt Shingles	Bath(s) Style 9 None	3.C Grade 6.AA Grade 9.Same
1.Asphalt 4.Composit 7.SS	1.Modern 4.Obsolete 7.	SQFT (Footprint) 624
2.Slate 5.Wood 8.	2.Typical 5. 8.	Condition 2 Fair
3.Metal 6.Other 9.	3.Old Type 6. 9.None	1.Poor 4.Avg 7.V G
SF Masonry Trim 0	# Rooms 1	2.Fair 5.Avg+ 8.Exc
OPEN-3-CUSTOM 0	# Bedrooms 0	3.Avg- 6.Good 9.Same
OPEN-4-CUSTOM 0	# Full Baths 0	Phys. % Good 0%
Year Built 1993	# Half Baths 0	Funct. % Good 100%
Year Remodeled 0	# Addn Fixtures 0	Functional Code 9 None
Foundation 6 Piers	# Fireplaces 0	1.Incomp 4.Long Ter 7.Damage
1.Concrete 4.Wood 7.		2.O-Built 5.Dilapid 8.Basement
2.C Block 5.Slab 8.		3.MoHoNoLa 6.Util/Lay 9.None
3.Br/Stone 6.Piers 9.		Econ. % Good 100%
Basement 5 Crawl Space		Economic Code None
1.1/4 Bmt 4.Full Bmt 7.		0.None 9.None 7.
2.1/2 Bmt 5.Crawl Sp 8.		1.Location 5. 8.
3.3/4 Bmt 6. 9.None		2.Encroach 6. 9.
Bsmt Gar # Cars 0		Entrance Code 5 Estimated
Wet Basement 9 No Basement		1.Interior 4.Vacant 7.
1.Dry 4. 7.		2.Refusal 5.Estimate 8.
2.Damp 5. 8.	3.Informed 6. 9.	
3.Wet 6. 9.	Information Code 5 Estimate	
	1.Owner 4.Agent 7.	
	2.Relative 5.Estimate 8.	
	3.Tenant 6.Other 9.	

Date Inspected 8/01/2024

Additions, Outbuildings & Improvements

Type	Year	Units	Grade	Cond	Phys.	Funct.	Sound Value
1 1 Story Frame	1993	32	2 100	2	0 %	100 %	
61 Canopy/Carport	1993	260	2 100	2	0 %	100 %	
68 Wood Deck	1993	192	2 100	2	0 %	100 %	
					%	%	
					%	%	
					%	%	
					%	%	
					%	%	
					%	%	
					%	%	

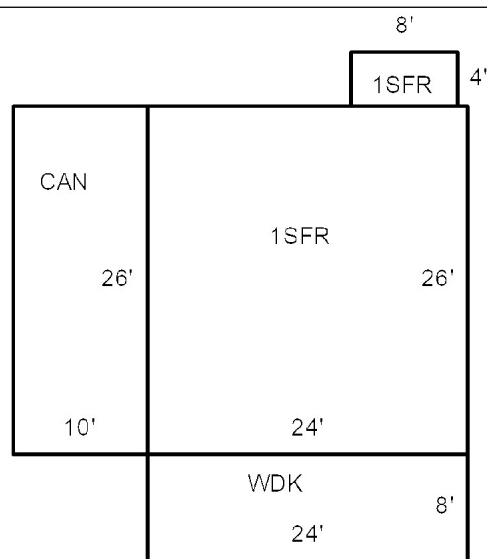

- 1.1 Story Frame
- 2.2 Story Frame
- 3.3 Story Frame
- 4.1-1/2 Story Fr
- 5.1-3/4 Story Fr
- 6.2-1/2 Story Fr
- 21.Open Frame Por
- 22.Encl Frame Por
- 23.Frame Garage
- 24.Frame Shed
- 25.Frame Bay Wind
- 26.1SFr Overhang
- 27.Unfin Basement
- 28.Unfinished Att
- 29.Finished Attic