



**Windsor**

Map Lot 01-079-T

Account 906

Location 332 COOPERS MILLS ROAD

Card 1 Of 1 10/15/2024

Building Style	SF Bsmt Living	Layout
1.Conv. 5.Garrison 9.Other	Fin Bsmt Grade	1.Typical 4. 7.
2.Ranch 6.Split 10.Cottage	Secondary heat	2.Inadeq 5. 8.
3.R Ranch 7.Contemp 11.Mobile	Heat Type <b>100%</b>	3. 6. 9.
4.Cape 8.Log 12.Gar/Apt	1.HW 5.FWA 9.No Heat	Attic
Dwelling Units	2.HWCI 6.GravWA 10.Radiant	1.1/4 Fin 4.Full Fin 7.
Other Units	3.H Pump 7.Electric 11.	2.1/2 Fin 5.FI/Stair 8.
Stories	4.Steam 8.Monitor/ 12.	3.3/4 Fin 6. 9.None
1.1 4.1.5 7.	Cool Type <b>0%</b>	Insulation
2.2 5.1.75 8.	1.Refrig 4.W&C Air 7.	1.Full 4.Minimal 7.
3.3 6.2.5 9.	2.Evapor 5. 8.	2.Heavy 5. 8.
Exterior Walls	3.H Pump 6. 9.None	3.Capped 6. 9.None
1.Wood 5.Stucco 9.Other	Kitchen Style	Unfinished %
2.Vin/Al 6.Brick 10.Cement	1.Modern 4.Obsolete 7.	Grade & Factor
3.Compos. 7.Stone 11.	2.Typical 5. 8.	1.E Grade 4.B Grade 7.
4.Asbestos 8.Concrete 12.	3.Old Type 6. 9.None	2.D Grade 5.A Grade 8.SC Grade
Roof Surface	Bath(s) Style	3.C Grade 6.AA Grade 9.Same
1.Asphalt 4.Composit 7.SS	1.Modern 4.Obsolete 7.	SQFT (Footprint)
2.Slate 5.Wood 8.	2.Typical 5. 8.	Condition
3.Metal 6.Other 9.	3.Old Type 6. 9.None	1.Poor 4.Avg 7.V G
SF Masonry Trim	# Rooms	2.Fair 5.Avg+ 8.Exc
OPEN-3-CUSTOM	# Bedrooms	3.Avg- 6.Good 9.Same
OPEN-4-CUSTOM	# Full Baths	Phys. % Good
Year Built	# Half Baths	Funct. % Good
Year Remodeled	# Addn Fixtures	Functional Code
Foundation	# Fireplaces	1.Incomp 4.Long Ter 7.Damage
1.Concrete 4.Wood 7.	 <p><b>TRIO</b> Software A Division of Harris Computer Systems</p>	2.O-Built 5.Dilapida 8.Basement
2.C Block 5.Slab 8.		3.MoHoNoLa 6.Util/Lay 9.None
3.Br/Stone 6.Piers 9.		Econ. % Good
Basement		Economic Code
1.1/4 Bmt 4.Full Bmt 7.	0.None 9.None 7.	1.Location 5. 8.
2.1/2 Bmt 5.Crawl Sp 8.	1.Encroach 6. 9.	2.Encroach 6. 9.
3.3/4 Bmt 6. 9.None	Entrance Code <b>5 Estimated</b>	Information Code <b>5 Estimate</b>
Bsmt Gar # Cars	1.Interior 4.Vacant 7.	1.Owner 4.Agent 7.
Wet Basement	2.Refusal 5.Estimate 8.	2.Relative 5.Estimate 8.
1.Dry 4. 7.	3.Informed 6. 9.	3.Tenant 6.Other 9.
2.Damp 5. 8.	Information Code <b>5 Estimate</b>	
3.Wet 6. 9.	1.Owner 4.Agent 7.	
	2.Relative 5.Estimate 8.	
	3.Tenant 6.Other 9.	

Date Inspected 7/25/2024

**Additions, Outbuildings & Improvements**

Type	Year	Units	Grade	Cond	Phys.	Funct.	Sound Value
24 Frame Shed	1980	48	3 100	1	0 %	100 %	
68 Wood Deck	1980	64	2 100	2	0 %	100 %	
74 Water In	1980	1	1 100	1	0 %	100 %	
75 Water Out	1980	1	1 100	1	0 %	100 %	
24 Frame Shed	1980	64	3 100	2	0 %	100 %	
997 12' MOBILE	1972	12x56	1 100	1	0 %	50 %	
					%	%	
					%	%	
					%	%	
					%	%	

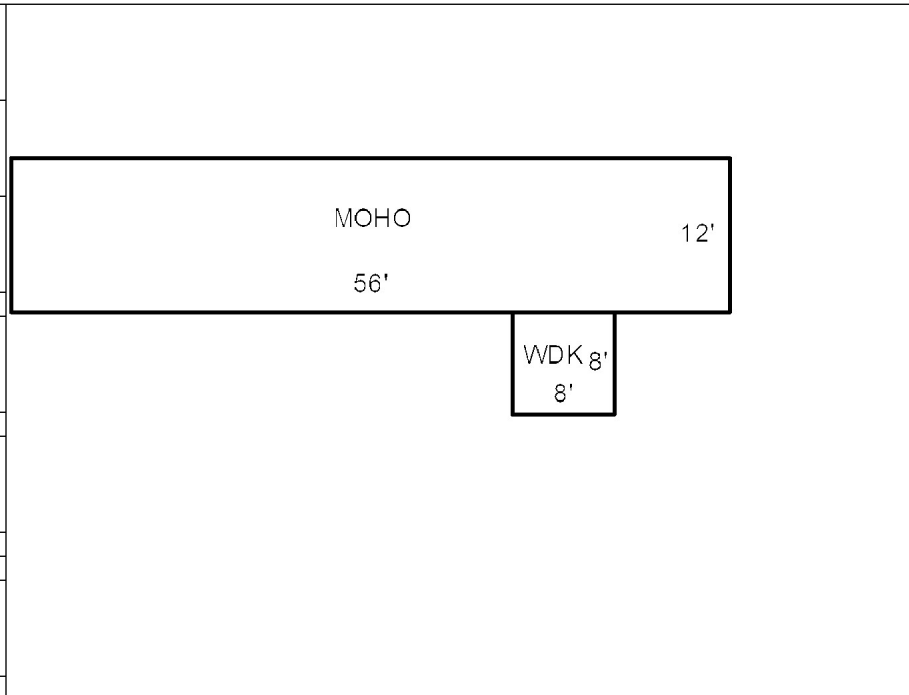

- 1.1 Story Frame
- 2.2 Story Frame
- 3.3 Story Frame
- 4.1-1/2 Story Fr
- 5.1-3/4 Story Fr
- 6.2-1/2 Story Fr
- 21.Open Frame Por
- 22.Encl Frame Por
- 23.Frame Garage
- 24.Frame Shed
- 25.Frame Bay Wind
- 26.1SFr Overhang
- 27.Unfin Basement
- 28.Unfinished Att
- 29.Finished Attic