

EWEN, AMY L
4 WALKER WAY
SIDNEY ME 04330

B11313P47

Previous Owner
EWEN, MARION E.
P.O. BOX 55

COOPERS MILLS ME 04341
Sale Date: 4/17/2006

Inspection Witnessed By:

No./Date	Description	Date Insp.
X		

Notes:
1/24 GL MI - EA EST IA, AGP=28' DIA
7/24 PB FR

Windsor

Property Data			Assessment Record						
Neighborhood 11 Nbhd 11			Year	Land	Buildings	Exempt	Total		
Tree Growth Year 0			2011	18,000	94,400	0	112,400		
Open Space (Year) 0			2012	18,000	94,400	0	112,400		
Farmland (Year) 0			2013	18,000	94,400	0	112,400		
Zone/Land Use 11 Rur Agricultural			2014	18,000	94,400	0	112,400		
Secondary Zone			2015	18,000	94,400	0	112,400		
Topography 3 Above Street			2016	18,000	94,400	0	112,400		
1.Level 4.Below St 7.			2017	18,000	94,400	0	112,400		
2.Rolling 5.Low 8.			2018	18,000	94,400	0	112,400		
3.Above St 6.Swampy 9.			2019	18,000	94,400	0	112,400		
Utilities 4 Drilled Well 6 Septic System			2020	18,000	94,400	0	112,400		
1.Public 4.Dr Well 7.Cesspool			2021	18,000	94,400	0	112,400		
2.Water 5.Dug Well 8.Lake Water			2022	18,000	94,400	0	112,400		
3.Sewer 6.Septic 9.None			2023	18,000	94,400	0	112,400		
Street 3 Gravel			2024	35,600	183,400	0	219,000		
1.Paved 4.Proposed 7.			Land Data						
2.Semi Imp 5. 8.									
3.Gravel 6. 9.None			Front Foot	Type	Effective		Influence		Influence Codes
INSPECTION CODE 0			11.Commercial Lot		Frontage	Depth	Factor	Code	
PRINT CARD 0			12.Not Used				%		1.Open Space Red
Sale Data			13.Commercial Lot				%		2.Excess Frtg
Sale Date			14.Not Used				%		3.Topography
Price			15.Miscellaneous				%		4.Size/Shape
Sale Type							%		5.Access
1.Land 4.Mobile 7.			Square Foot	Square Feet					6.Restriction
2.L & B 5.Other 8.			16.Gravel Pit Sit				%		7.Corner Infl
3.Building 6. 9.			17.Gravel Pit Pot				%		8.View/Environ
Financing			18.Excess Land				%		9.Fract Share
1.Convent 4.Seller 7.			19.Condominium				%		Acres
2.FHA/VA 5.Private 8.			20.Miscellaneous				%		30.Prime Lot
3.Assumed 6.Cash 9.Unknown							%		31.Blueberry/Hort
Validity			Fract. Acre	Acres/Sites					32.Pasture
1.Valid 4.Split 7.Renovate			21.Residential Lo	21	1.00	100	%	0	33.Orchard
2.Related 5.Partial 8.Other			22.Not Used	22	1.00	100	%	0	34.Software(Farm
3.Distress 6.Exempt 9.Trust			23.Waterfront Lot	25	1.00	100	%	0	35.Mixed Wood (Fa
Verified			Acres				%		36.Hardwood (Farm
1.Buyer 4.Agent 7.Family			24.Not Used				%		37.Software
2.Seller 5.Pub Rec 8.Other			25.Excess Land (1				%		38.Mixed Wood
3.Lender 6.MLS 9.			26.Excess Land (1				%		39.Hardwood
			27.Excess Land (>				%		40.Wasteland
			28.Excess Land WF				%		41.Miscellaneous
			29.Not Used				%		42.Mobile Home Si
			Total Acreage		2.00				43.Condo Site
									44.Lot Improvemen
									45.Utility Valuat
									46.Miscellaneous

Windsor

Map Lot 01-054-B

Account 431

Location 27 EWEN ROAD

Card 1 Of 1 10/15/2024

Building Style 2 Ranch	SF Bsmt Living 0	Layout 1 Typical
1.Conv. 5.Garrison 9.Other	Fin Bsmt Grade 0 0	1.Typical 4. 7.
2.Ranch 6.Split 10.Cottage	Secondary heat 0	2.Inadeq 5. 8.
3.R Ranch 7.Contemp 11.Mobile	Heat Type 100% 5 Forced Warm Air	3. 6. 9.
4.Cape 8.Log 12.Gar/Apt	1.HW 5.FWA 9.No Heat	Attic 9 None
Dwelling Units 1	2.HWCI 6.GravWA 10.Radiant	1.1/4 Fin 4.Full Fin 7.
Other Units 0	3.H Pump 7.Electric 11.	2.1/2 Fin 5.FI/Stair 8.
Stories 1 One Story	4.Steam 8.Monitor/ 12.	3.3/4 Fin 6. 9.None
1.1 4.1.5 7.	Cool Type 0% 9 None	Insulation 1 TYPICAL
2.2 5.1.75 8.	1.Refrig 4.W&C Air 7.	1.Full 4.Minimal 7.
3.3 6.2.5 9.	2.Evapor 5. 8.	2.Heavy 5. 8.
Exterior Walls 1 Wood Siding	3.H Pump 6. 9.None	3.Capped 6. 9.None
1.Wood 5.Stucco 9.Other	Kitchen Style 2 Typical	Unfinished % 0%
2.Vin/Al 6.Brick 10.Cement	1.Modern 4.Obsolete 7.	Grade & Factor 3 Average 100%
3.Compos. 7.Stone 11.	2.Typical 5. 8.	1.E Grade 4.B Grade 7.
4.Asbestos 8.Concrete 12.	3.Old Type 6. 9.None	2.D Grade 5.A Grade 8.SC Grade
Roof Surface 7 Standing Seam	Bath(s) Style 2 Typical Bath(s)	3.C Grade 6.AA Grade 9.Same
1.Asphalt 4.Composit 7.SS	1.Modern 4.Obsolete 7.	SQFT (Footprint) 810
2.Slate 5.Wood 8.	2.Typical 5. 8.	Condition 4 Average
3.Metal 6.Other 9.	3.Old Type 6. 9.None	1.Poor 4.Avg 7.V G
SF Masonry Trim 0	# Rooms 4	2.Fair 5.Avg+ 8.Exc
OPEN-3-CUSTOM 0	# Bedrooms 2	3.Avg- 6.Good 9.Same
OPEN-4-CUSTOM 0	# Full Baths 2	Phys. % Good 0%
Year Built 1989	# Half Baths 0	Funct. % Good 100%
Year Remodeled 0	# Addn Fixtures 0	Functional Code 9 None
Foundation 1 Concrete	# Fireplaces 0	1.Incomp 4.Long Ter 7.Damage
1.Concrete 4.Wood 7.		2.O-Built 5.Dilapida 8.Basement
2.C Block 5.Slab 8.		3.MoHoNoLa 6.Util/Lay 9.None
3.Br/Stone 6.Piers 9.		Econ. % Good 100%
Basement 4 Full Basement		Economic Code None
1.1/4 Bmt 4.Full Bmt 7.		0.None 9.None 7.
2.1/2 Bmt 5.Crawl Sp 8.		1.Location 5. 8.
3.3/4 Bmt 6. 9.None		2.Encroach 6. 9.
Bsmt Gar # Cars 1		Entrance Code 5 Estimated
Wet Basement 1 Dry Basement		1.Interior 4.Vacant 7.
1.Dry 4. 7.		2.Refusal 5.Estimate 8.
2.Damp 5. 8.	3.Informed 6. 9.	
3.Wet 6. 9.	Information Code 5 Estimate	
	1.Owner 4.Agent 7.	
	2.Relative 5.Estimate 8.	
	3.Tenant 6.Other 9.	

Date Inspected 7/25/2024

Additions, Outbuildings & Improvements

Type	Year	Units	Grade	Cond	Phys.	Funct.	Sound Value
26 1SFr Overhang	1989	44	3 100	3	0 %	100 %	
21 Open Frame	1989	128	3 100	3	0 %	100 %	
68 Wood Deck	1989	24	3 100	3	0 %	100 %	
24 Frame Shed	1989	192	3 100	3	0 %	100 %	
24 Frame Shed	1989	64	1 100	1	0 %	100 %	
68 Wood Deck	1989	144	3 100	4	0 %	100 %	
73 Above ground	2023	1	3 100	4	0 %	100 %	
43 2S Frame Garage	1989	378	3 100	4	0 %	100 %	
					%	%	
					%	%	

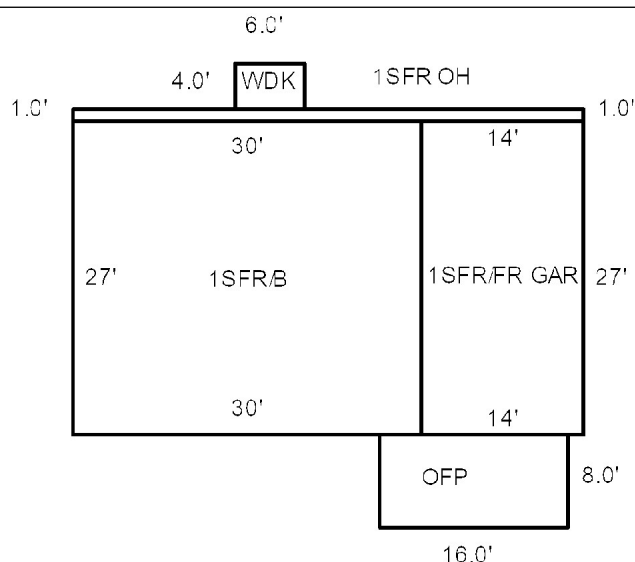

- 1.1 Story Frame
- 2.2 Story Frame
- 3.3 Story Frame
- 4.1-1/2 Story Fr
- 5.1-3/4 Story Fr
- 6.2-1/2 Story Fr
- 21.Open Frame Por
- 22.Encl Frame Por
- 23.Frame Garage
- 24.Frame Shed
- 25.Frame Bay Wind
- 26.1SFr Overhang
- 27.Unfin Basement
- 28.Unfinished Att
- 29.Finished Attic